

JOB NO.	CODE	SCALE	DATE FLOWN
1773	DOR 1773	1"=2000'	10-21-75
2168	PD 2168	1"=200'	1-28-76
			4-7-76
			12-6-77

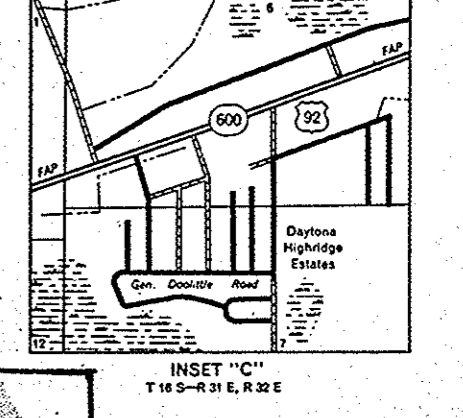
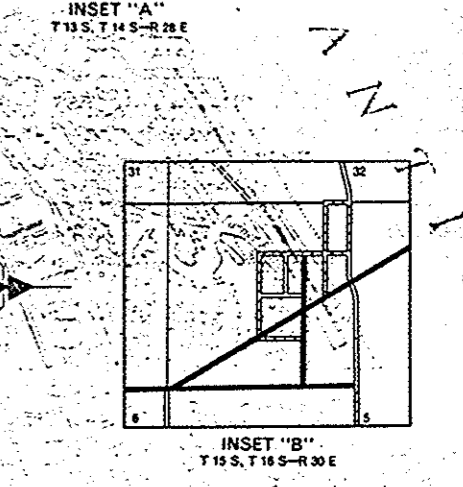
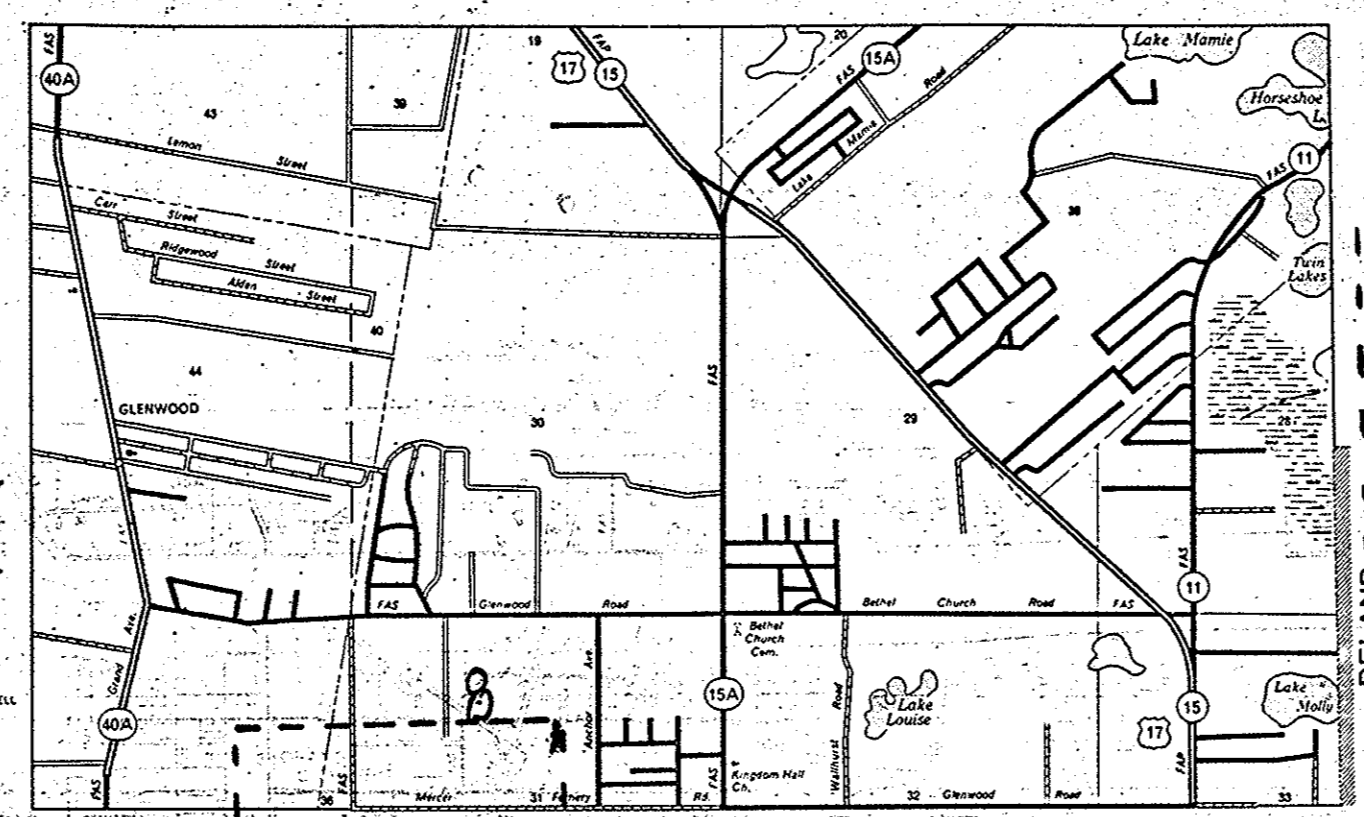

**GENERAL HIGHWAY MAP  
VOLUSIA COUNTY  
FLORIDA**

SCALE 1"=2000'  
SCALE FOR INSETS  
1"=200'

REVISIONS

FEATURE	DATE
State Maintained Roads	Sept. 1974

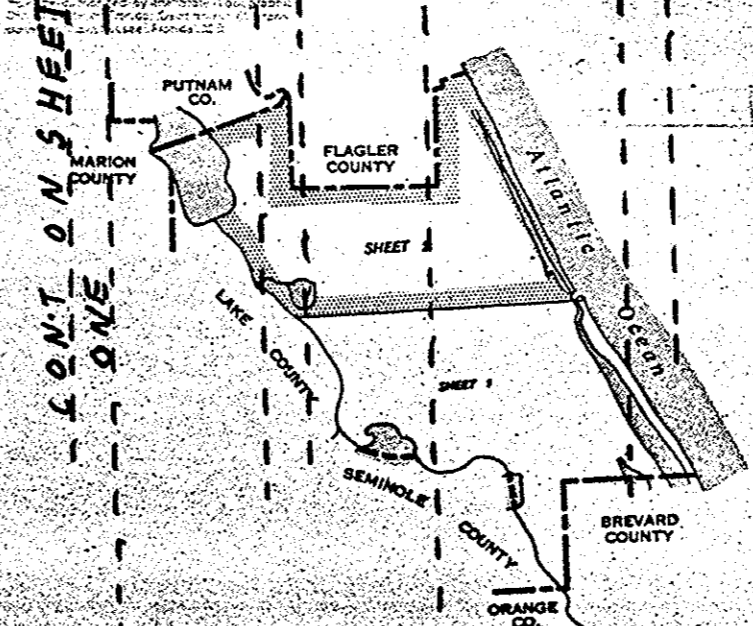

CONT. ON SHEET  
ONE

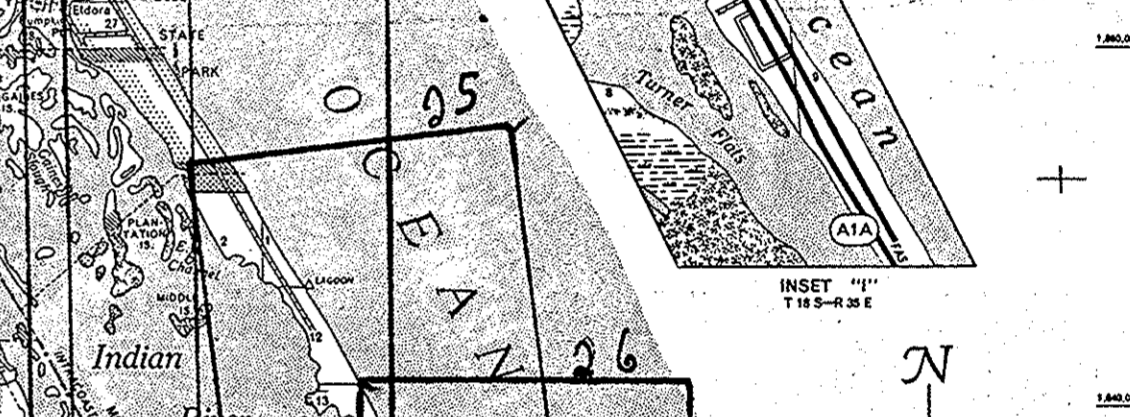
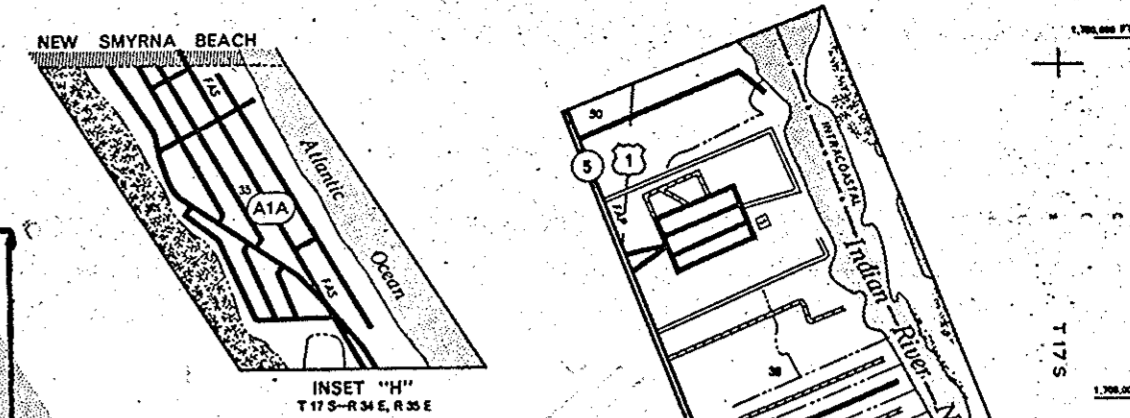
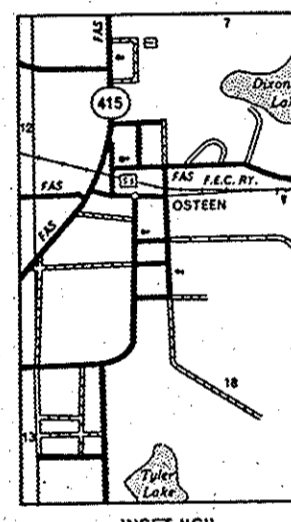
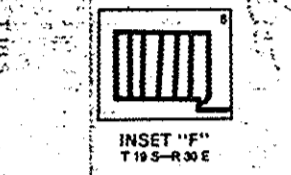
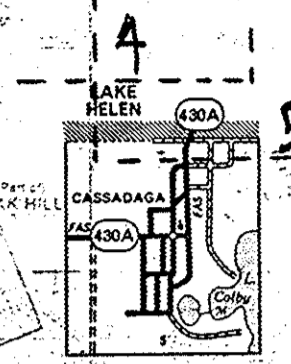
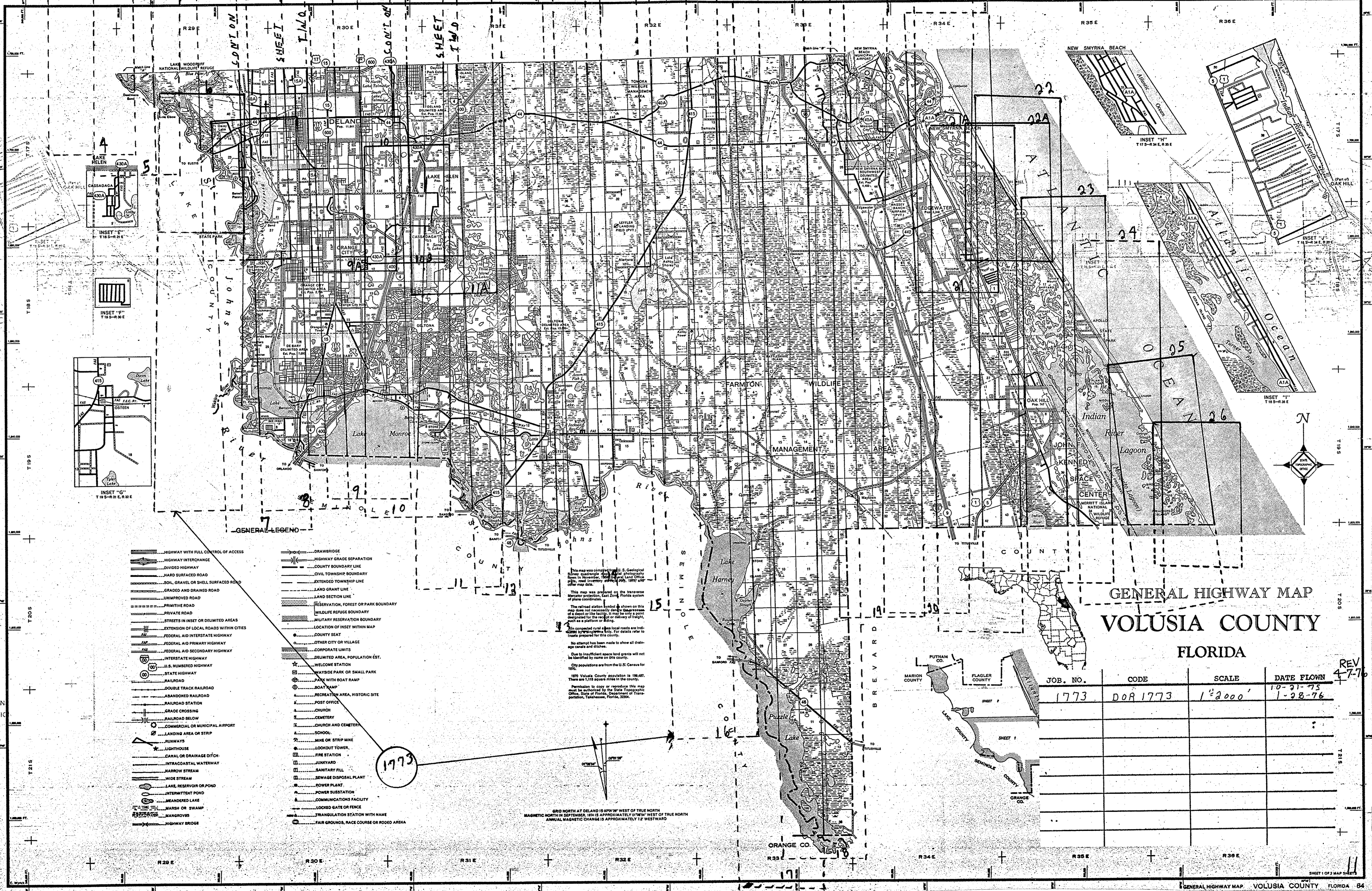

GENERAL LEGEND

- HIGHWAY WITH FULL CONTROL OF ACCESS
- HIGHWAY INTERCHANGE
- DIVIDED HIGHWAY
- HARD SURFACED ROAD
- SOIL, GRAVEL OR SHELL SURFACED ROAD
- GRADED AND DRAINED ROAD
- UNIMPROVED ROAD
- PRIVATE ROAD
- PRIVATE ROAD
- STREETS IN INSET OR DELIMITED AREAS
- EXTENSION OF LOCAL ROADS WITHIN CITIES
- FEDERAL AID INTERSTATE HIGHWAY
- FEDERAL AID PRIMARY HIGHWAY
- FEDERAL AID SECONDARY HIGHWAY
- INTERSTATE HIGHWAY
- U.S. NUMBERED HIGHWAY
- STATE HIGHWAY
- RAILROAD
- DOUBLE TRACK RAILROAD
- ABANDONED RAILROAD
- RAILROAD STATION
- GRADE CROSSING
- RAILROAD BELOW
- COMMERCIAL OR MUNICIPAL AIRPORT
- LANDING AREA OR STRIP
- RUNWAYS
- LIGHTHOUSE
- CANAL OR DRAINAGE DITCH
- INTRACOASTAL WATERWAY
- NARROW STREAM
- WIDE STREAM
- LAKE, RESERVOIR OR POND
- INTERMITTENT POND
- MEANDERED LAKE
- MARSH OR SWAMP
- MANGROVES
- HIGHWAY BRIDGE
- DRAWBRIDGE
- HIGHWAY GRADE SEPARATION
- COUNTY BOUNDARY LINE
- CIVIL TOWNSHIP BOUNDARY
- EXTENDED TOWNSHIP LINE
- LAND GRANT LINE
- LAND SECTION LINE
- RESERVATION, FOREST OR PARK BOUNDARY
- WILDLIFE REFUGE BOUNDARY
- MILITARY RESERVATION BOUNDARY
- LOCATION OF INSET WITHIN MAP
- COUNTY SEAT
- OTHER CITY OR VILLAGE
- CORPORATE LIMITS
- DELIMITED AREA, POPULATION EST.
- WELCOME STATION
- WAYSIDE PARK OR SMALL PARK
- PARK WITH BOAT RAMP
- BOAT RAMP
- RECREATION AREA, HISTORIC SITE
- POST OFFICE
- CHURCH
- CEMETERY
- CHURCH AND CEMETERY
- SCHOOL
- MINE OR STRIP MINE
- LOOKOUT TOWER
- FIRE STATION
- JUNKYARD
- SANITARY FILL
- SEWAGE DISPOSAL PLANT
- POWER PLANT
- POWER SUBSTATION
- COMMUNICATIONS FACILITY
- LOCKED GATE OR FENCE
- TRIANGULATION STATION WITH NAME
- FAIR GROUNDS, RACE COURSE OR RODEO ARENA

This map was compiled by the U.S. Geological Survey, using aerial photography taken in November, 1969. Original Land Office data, road inventories, and other map data.

This map was prepared on the Universal Mercator projection, East Zone, Florida system of coordinates.

The railroad station symbol shown on this map does not necessarily denote the presence of a station on the facility. It may be only a point designated for the receipt or delivery of freight, such as a siding or siding.

No attempt has been made to show all drainage canals and ditches.

Due to insufficient space land grants will not be identified by name on this county.

City populations are from the U.S. Census for 1970.

1970 Volusia County population is 108,427. There are 1,118 square miles in the county.

Permission to copy or reproduce this map must be authorized by the State Topographic Office, State of Florida, Department of Transportation, Tallahassee, Florida, 32304.

GENERAL HIGHWAY MAP  
VOLUSIA COUNTY  
FLORIDA

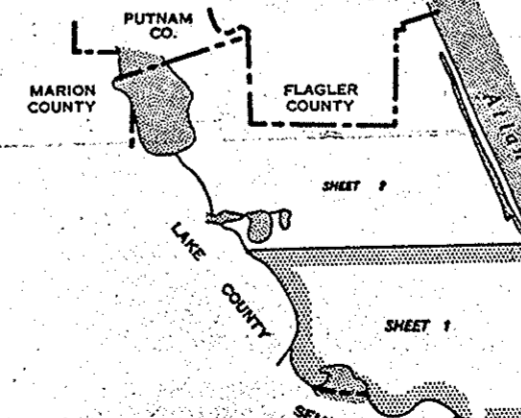

JOB. NO.	CODE	SCALE	DATE FLOWN
1773	DOR 1773	1"=2000'	10-21-75
			1-28-76

REV 4-7-76

GRID NORTH AT DELAND IS 0°01'30" WEST OF TRUE NORTH  
MAGNETIC NORTH IN SEPTEMBER, 1974 IS APPROXIMATELY 0°04' WEST OF TRUE NORTH  
ANNUAL MAGNETIC CHANGE IS APPROXIMATELY 1/2" WESTWARD